

5. SPEAKER CONNECTION

This equipment, being a high audio output power amplifier, has a hazardous energy at its speaker terminal. Please be sure to make an appropriate speaker connection according to the following procedures:

- * Confirm that the power switch of the equipment is at "OFF" position. If it is at "ON", turn it to "OFF" position to connect a speaker cable.
- * Use a speaker cable with the flame retardant rating of Type SPT-2 or more.
- * Don't strip the insulation off more than shown in the figure, at the speaker terminal connection of speaker cable.

- * Connect the speaker cable to the speaker terminal.
- * Prevent the speaker cable from being disconnected.
- * Don't touch the speaker terminal when the equipment is powered on.

Speaker cable (Type SPT-2)

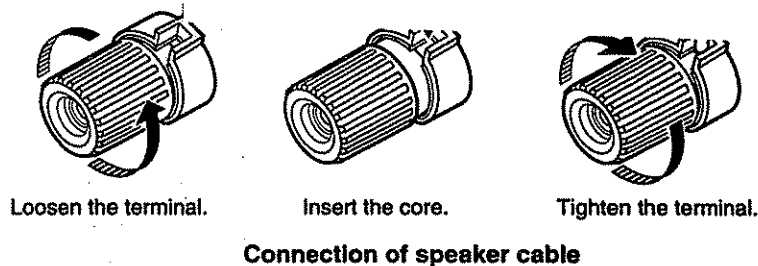
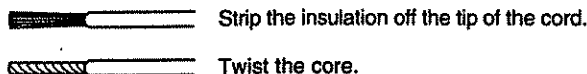

6. CARE AND MAINTENANCE

This section describes the care and maintenance tasks that must be performed to optimize the operation of your Marantz equipment.

CLEANING OF EQUIPMENT EXTERNAL SURFACES

The exterior finish of your unit will last indefinitely with proper care and cleaning. Never use scouring pads, steel wool, scouring powders or harsh chemical agents (e.g., lye solution), alcohol, thinners, benzene, insecticide or other volatile substances as these will mar the finish of the equipment. Likewise, never use cloths containing chemical substances. If the equipment gets dirty, wipe the external surfaces with a soft, lint-free cloth.

If the equipment becomes heavily soiled:

- dilute some washing up liquid in water, in a ratio of one part detergent to six parts water.
- dip a soft, lint free cloth in the solution and wring the cloth out until it is damp.
- wipe the equipment with the damp cloth.
- dry the equipment by wiping it with a dry cloth.

7. REPAIRS

Only the most competent and qualified technicians should be allowed to service your unit. Marantz and its factory trained warranty station personnel have the knowledge and special equipment needed for repair and calibration of this precision instrument.

In the event of difficulty, call the toll-free telephone number listed on the face of the warranty to obtain the name and address of the Marantz Authorized Service Center nearest you. In many cases, the dealer where you purchased your Marantz unit may be equipped to provide service. Please include the model, serial number of your unit together with a copy of your purchase receipt and a full description of what you feel is abnormal in its behavior.

8. TROUBLESHOOTING

The amplifier does not operate and the POWER ON indicator does not light.

- Is the power cable plugged in properly to the AC power outlet?

The POWER ON indicator lights, but the amplifier does not function.

- Are speaker cables and input cables connected properly?

9. SPECIFICATION

Rated output	200 W	8-ohm, rms
Distortion	0.02 %	
Rated input level	1 V rms	
Frequency response (-1 dB)	5 Hz to 100 kHz	
S/N ratio	110 dB	
Damping factor (1 kHz)	200	
Power supply	120 V AC, 60 Hz	
Power consumption	220 W	
	(Stand-by) 3.5 W	

Dimensions

Width	145 mm
Height	146 mm
Depth	472 mm
Weight	8 kg

Accessories

Remote control cable	x 1
Speaker cable for BTL connection	x 1
Audio cable	x 1

Design and specifications are subject to change without notice.